

APPENDIX 2

MATERIAL STORAGE YARD DRAWINGS

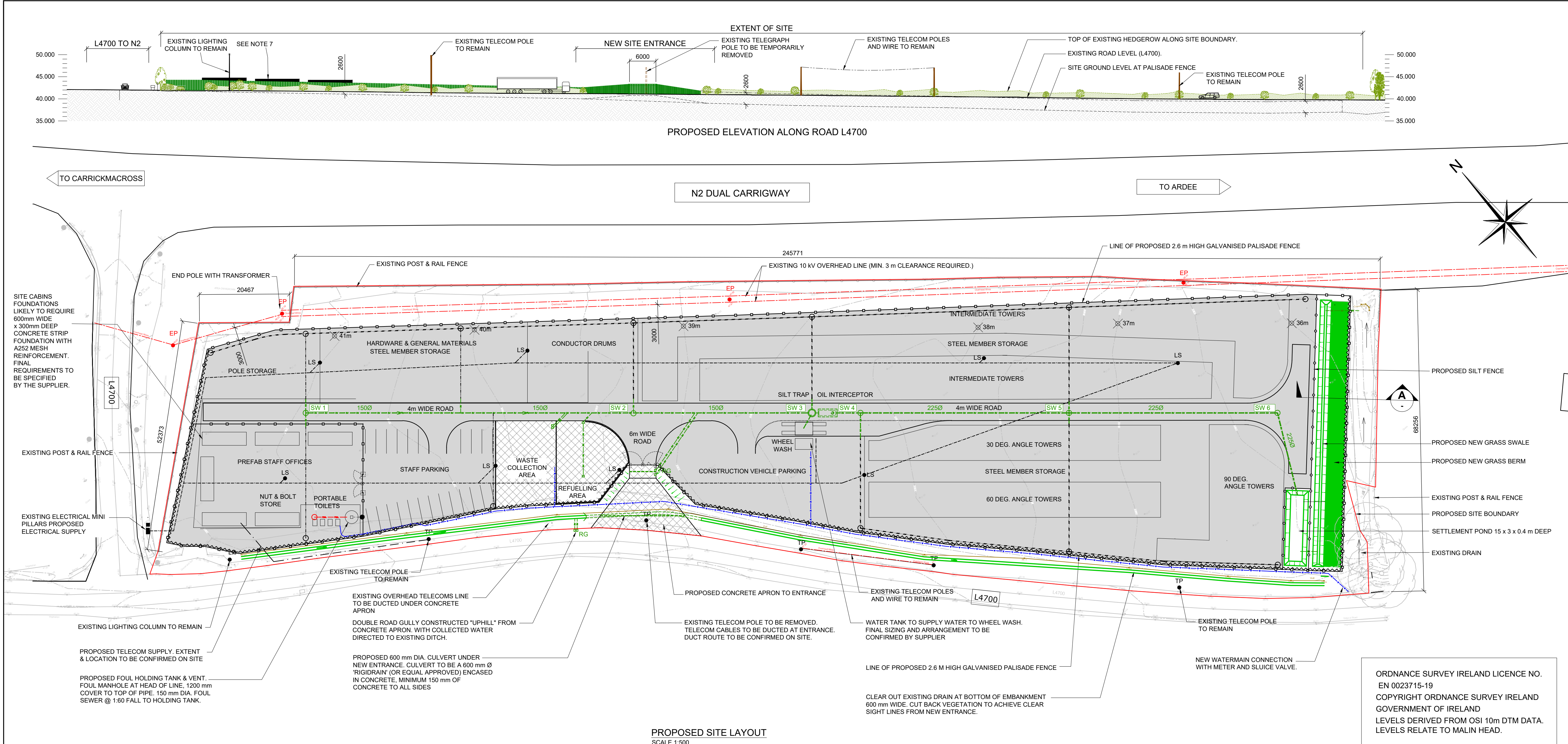



0m 10m 20m 30m 40m

NOTES:

- ROAD, PARKING AND STORAGE AREA SURFACES TO BE CONSTRUCTED USING COMPACTED STONE. REFER TO DETAILS.
- APPROXIMATE SITE AREA 1.4 HECTARES. CONTRACTOR IS RESPONSIBLE FOR DETERMINING SITE AREA.
- FIGURED DIMENSIONS ONLY TO BE TAKEN FROM THIS DRAWING.
- CONFIGURATION OF STAFF FACILITIES SHOWN IS INDICATIVE.
- NOISE BARRIER TO BE STAND ALONE FENCE UNLESS OTHERWISE AGREED WITH THE ENGINEER AT CONSTRUCTION STAGE.
- NO PERMANENT RACKING OR SHELVING PROPOSED FOR STORAGE WITHIN THE FOLLOWING AREAS:
 - POLE STORAGE
 - HARDWARE AND GENERAL MATERIALS STORE
 - STEEL MEMBERS STORAGE
 - CONDUCTOR DRUMS
 - INTERMEDIATE TOWERS
 - 30° ANGLE TOWERS
 - 60° ANGLE TOWERS
 - 90° ANGLE TOWERS
- FOR SCALED PLANS AND ELEVATIONS OF STRUCTURES PROPOSED TO BE PLACED ON THE SITE REFER TO DRAWING PE687-D422-041-001.

SITE STRIP & STONE FILL:

- STRIP OFF EXISTING TOPSOIL AND GROUND.
- FORMATION TO BE TESTED WITH PLATE BEARING TESTS. (MIN. 5% GBR REQUIRED. A MINIMUM OF 10 No. CBR TESTS DISTRIBUTED EVENLY ACROSS THE SITE ARE REQUIRED. SHOULD RESULTS VARY SIGNIFICANTLY, ADDITIONAL TESTING WILL BE REQUIRED.
- SOFT SPOTS TO BE EXCAVATED OUT AND FILLED WITH COMPACTED 6F2 MATERIAL.
- GEOTEXTILE TERRAM 1000 PLACED ON FORMATION.
- LAYER OF COMPACTED 6F2 STONE ON
- LAYER OF COMPACTED UGM-A STONE.

SITE LEVELS TO BE REINSTATED SIMILAR TO EXISTING LEVELS. ~1/35 FALL NW TO SE.

STRIPPED MATERIAL REMOVED FROM SITE TO BE DISPOSED OF APPROPRIATELY IN A LICENSED FACILITY SUITABLE FOR THE CLASSIFICATION OF THE MATERIAL. CONTRACTOR TO UNDERTAKE WASTE ACCEPTANCE CRITERION TESTING TO DETERMINATE THE MATERIAL CLASSIFICATION.

LEGEND:

- PROPOSED TEMPORARY CONSTRUCTION / MATERIAL STORAGE YARD
- PROPOSED SURFACE WATER DRAIN (TWIN-WALL PIPES)
- PROPOSED FOUL DRAIN
- WATER SUPPLY PIPE 50 mm Ø HDPE.
- LV SUPPLY DUCTS FOR YARD LIGHTING 125 mm Ø
- COMMS DUCT 100 mm Ø
- FRENCH DRAIN 150 mm Ø PERFORATED PIPE
- CP - CATCH PIT
- 2.0 m HIGH TIMBER ACOUSTIC FENCE.
- NEW DARK GREEN POWDER COATED PALISADE FENCE (RAL 6005) WITH SOUND BARRIER ON EAST, WEST & SOUTH BOUNDARIES.
- NEW SILT FENCE.
- NEW RC APRON SLAB AREAS (721 m²)
- NEW STONED SITE AREAS (12,000 m²)
- EP - ELECTRICITY POLE
- TP - TELECOM'S POLE
- LS - LAMP STANDARD
- Existing GROUND LEVEL

No.	CL	IL
SW 1	41.000	39.650
SW 2	39.350	38.000
SW 3	38.250	36.900
SW 4	38.100	36.750
SW 5	37.250	35.900
SW 6	36.300	34.950

2	July 2025	CEMP ISSUE	-	-
1	Nov 2023	ISSUED FOR TENDER	MM	SF
REV	DATE	DESCRIPTION	BY	APP
PROJECT:				
TITLE:				
NORTH SOUTH 400 kV INTERCONNECTION DEVELOPMENT				
CLIENT:				
EIRGRID				
DRAWN:				
CHECKED:				
APPROVED:				
PROJECT NUMBER:				
TC211635				
DATE:				
Nov. 2023				
SCALE @ A1:				
1:500				
STATUS DESCRIPTION:				
FOR TENDER				
STATUS:				
D2				
DRAWING NUMBER:				
24051 - MWP - ZZ - ZZ - DR - C - 0102				
REV:				
2				

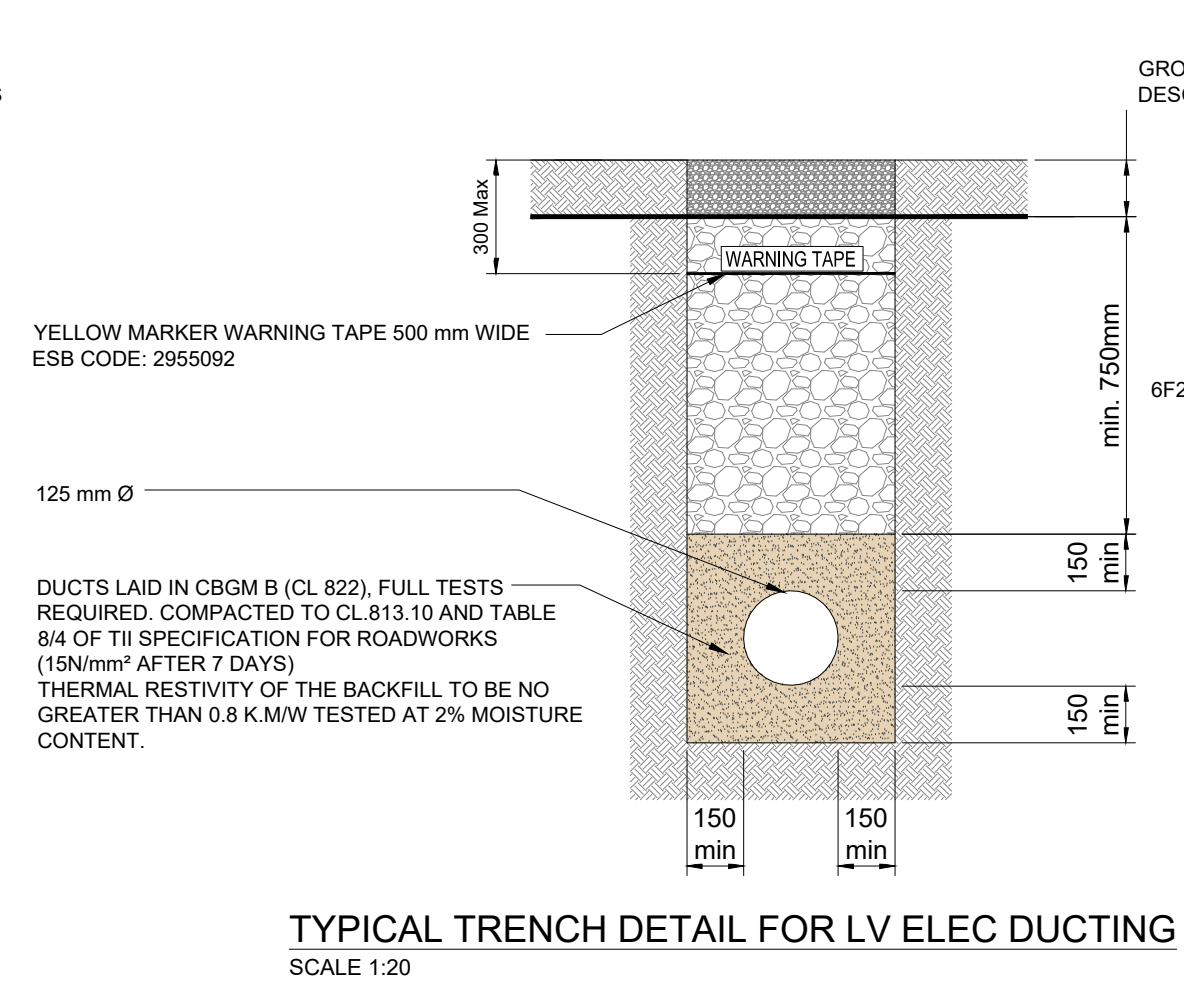
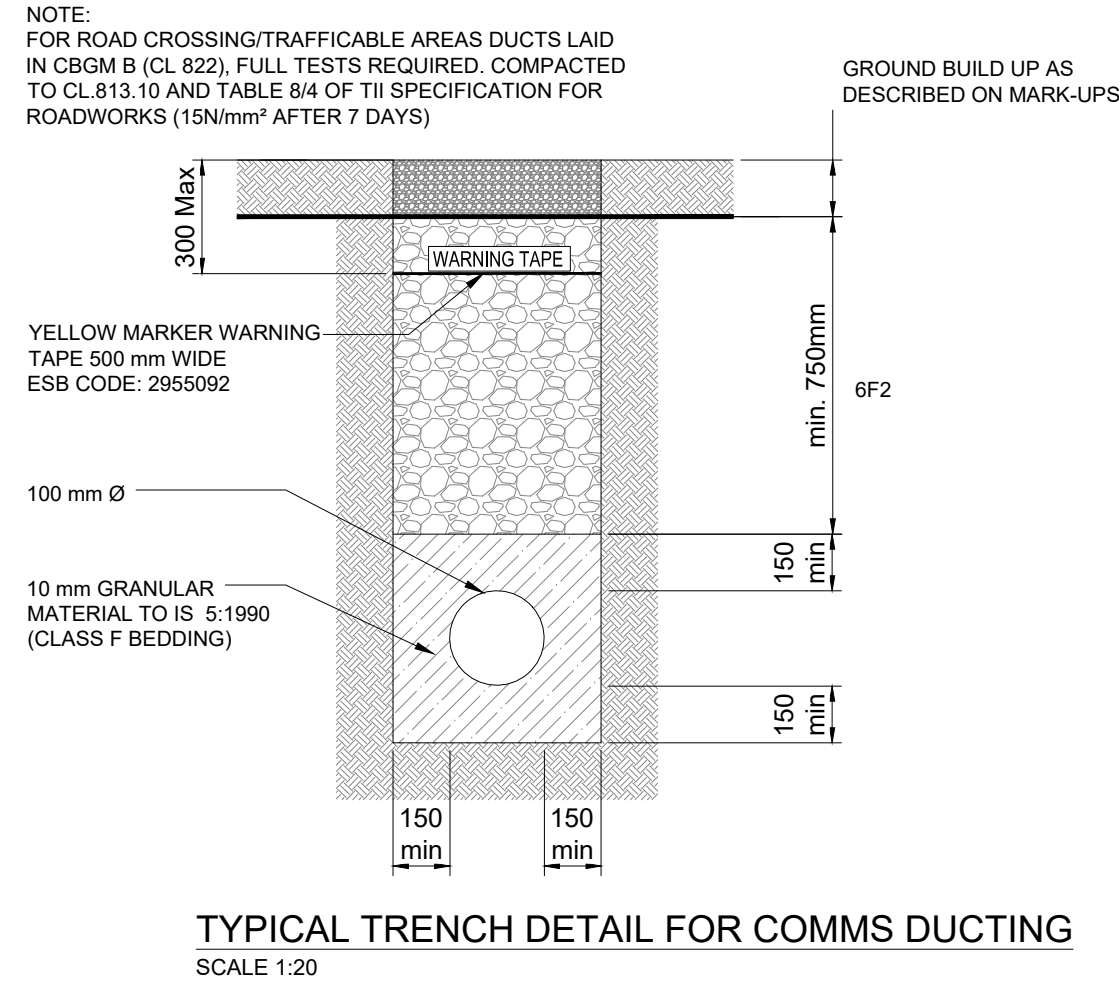
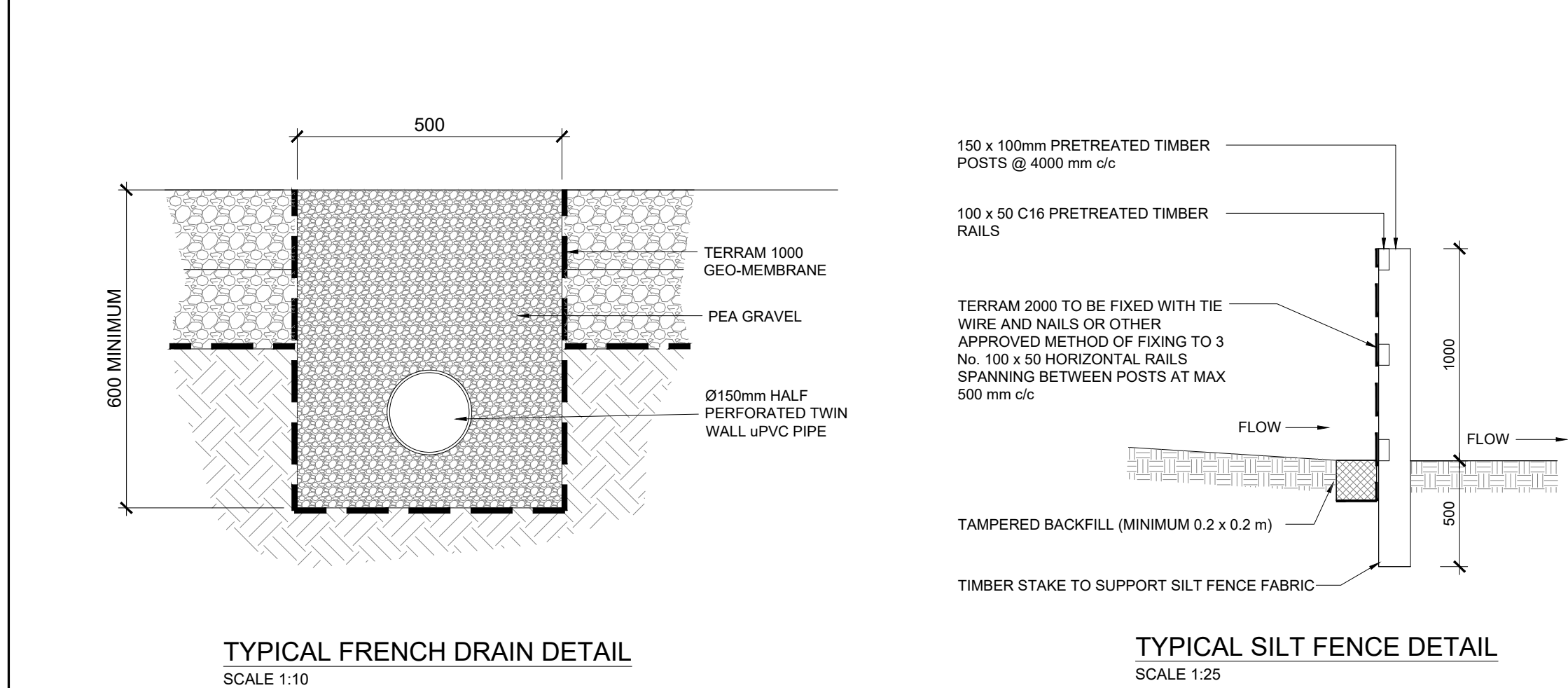
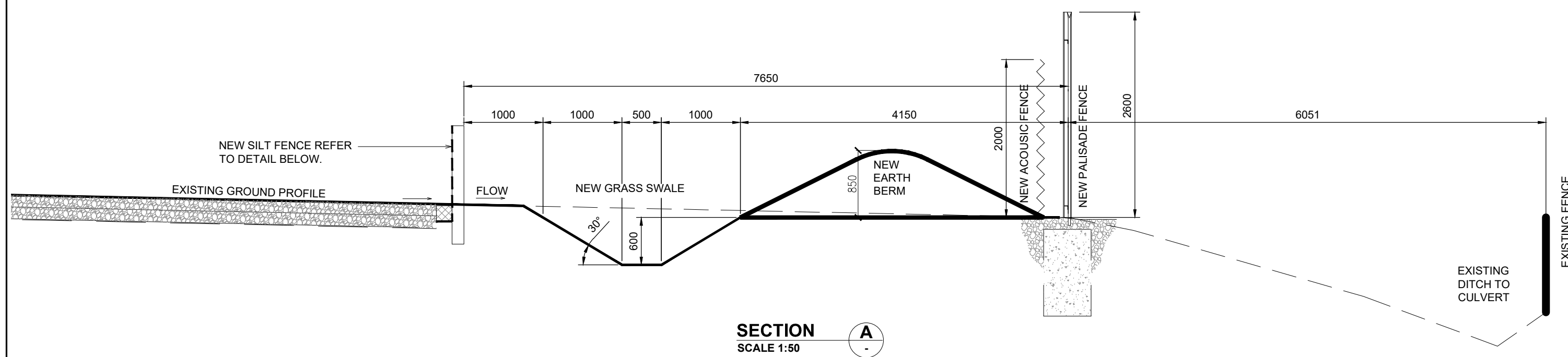

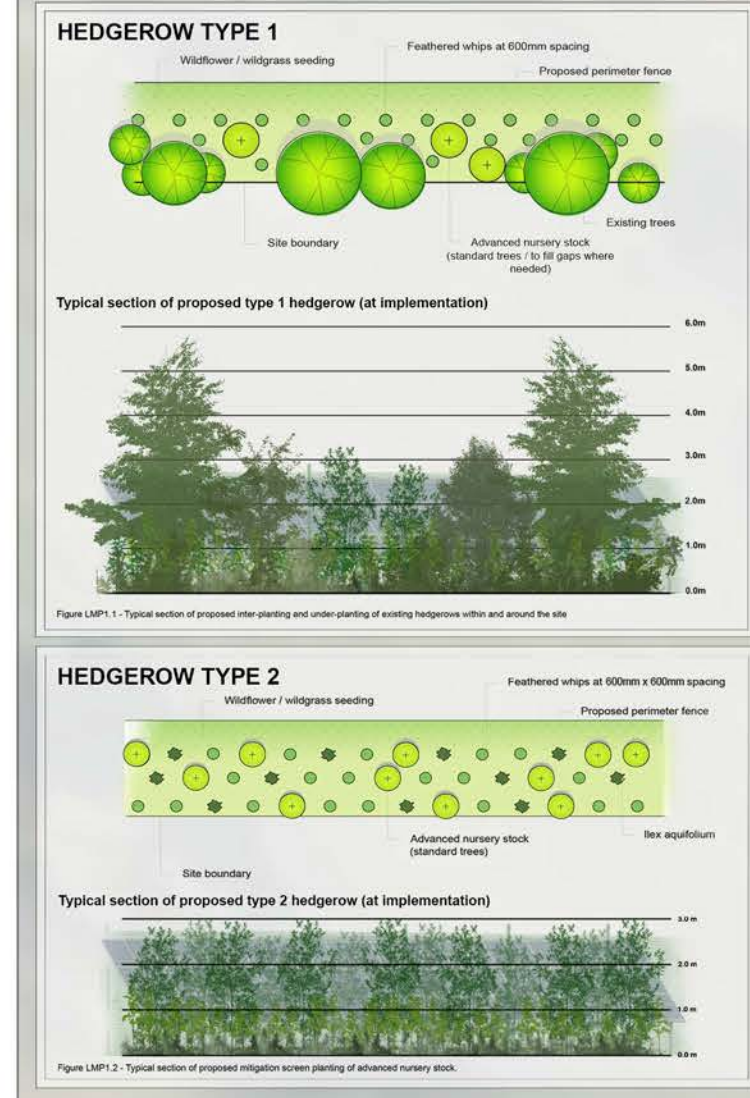

LEGEND:

-  Woodland
-  Wet grassland Mix
-  Site boundary
-  Berm
-  Advanced nursery stock
-  Proposed fence
-  Hedgerow Type 2

NOTES:

The function of the proposed mitigation planting is to support screening and to enhance biodiversity across the site. The new and bolstered sections of hedgerow vegetation, proposed woodland mix and wild grass verges will all reinforce the existing green infrastructure links and provide new ecological corridors within the site and throughout the wider landscape.

Mitigation screen planting shall consist of a mixture of native hedgerow species that are prevalent in the immediate area. Planting to consist of feathered whips (of various sizes) in staggered rows at a spacing of 600mm.

'Under-planting' to consist of a single row of whips to the development side of existing tree lines and hedgerows.

'Inter-planting' to consist of whips at 400mm centres to fill gaps in existing tree lines and hedgerows.

New sections of hedgerow to consist of a triple staggered row of whips and advanced nursery stock at 600mm spacing.

All native species will be planted as whips, with the primary and secondary structure species to be of a minimum height of 90cm and the other shrubs species to be of a minimum height of 60cm.

Proposed mitigation screen planting to be planted as per diagram LMP1.1-1.2 and maintained at a height of approximately 3-4m unless otherwise specified. Hedgerow type 1 to be planted as necessary for gap filling and bolstering.

Proposed mitigation to be planted in the first growing season prior to commencement of development. Hedgerows should reach full establishment (3-4 meters) within 2-3 years of planting.

Native grass seeding of local provenance to occupy any residual space between perimeter fence and nearest line of whip planting. Field margins to be managed inline with the BRIDE project management techniques.

Species mix to be finalised in conjunction with the project ecologist.

*Advanced nursery stock to be provided as Crataegus monogyna (Hawthorn) at 8-10cm girth (c. 3m) bare root standard trees.

NATIVE HEDGEROW SPECIES:

Botanical name	Common name	Size	%
<i>Primary structure;</i>			
Crataegus monogyna	Hawthorn	90-120cm / 8-10cm girth 3m br standard trees	60%
<i>Secondary structure;</i>			
Prunus spinosa	Blackthorn	90-120cm	15%
Ilex aquifolium	Holly	90-120cm	15%
<i>Shrub species structure;</i>			
Viburnum opulus	Guelder Rose	60-90cm	2.5%
Corylus avellana	Hazel	60-90cm	2.5%
Rosa canina	Dog-rose	60-90cm	2.5%
Euonymus europaeus	Spindle	60-90cm	2.5%



Ground Floor, Hibernia House
Cherrywood Business Park
Loughinstown, Dublin 18
Ireland
00353 (01) 2303585
info@macroworks.ie

PROJECT:

North South Interconnector
Storage Yard
Co. Monaghan

CLIENT:

ESB Major Projects

DRAWING:

Landscape Mitigation Plan - Sheet 1

SCALE:

1:500

DATE:

Jul 2025

DWN BY:

YA

CKD BY:

RB

SHEET SIZE:

A1 (landscape)

DWG No.

LD_NSINTER 3.1