

**N2 Monaghan Town to Emyvale, County Monaghan
Proposed Pavement and Minor Improvement Scheme**

**Coolkill East – Corracrin,
Part 8 Application, July 2011**

Appendix 10: Key Landscaping Proposals

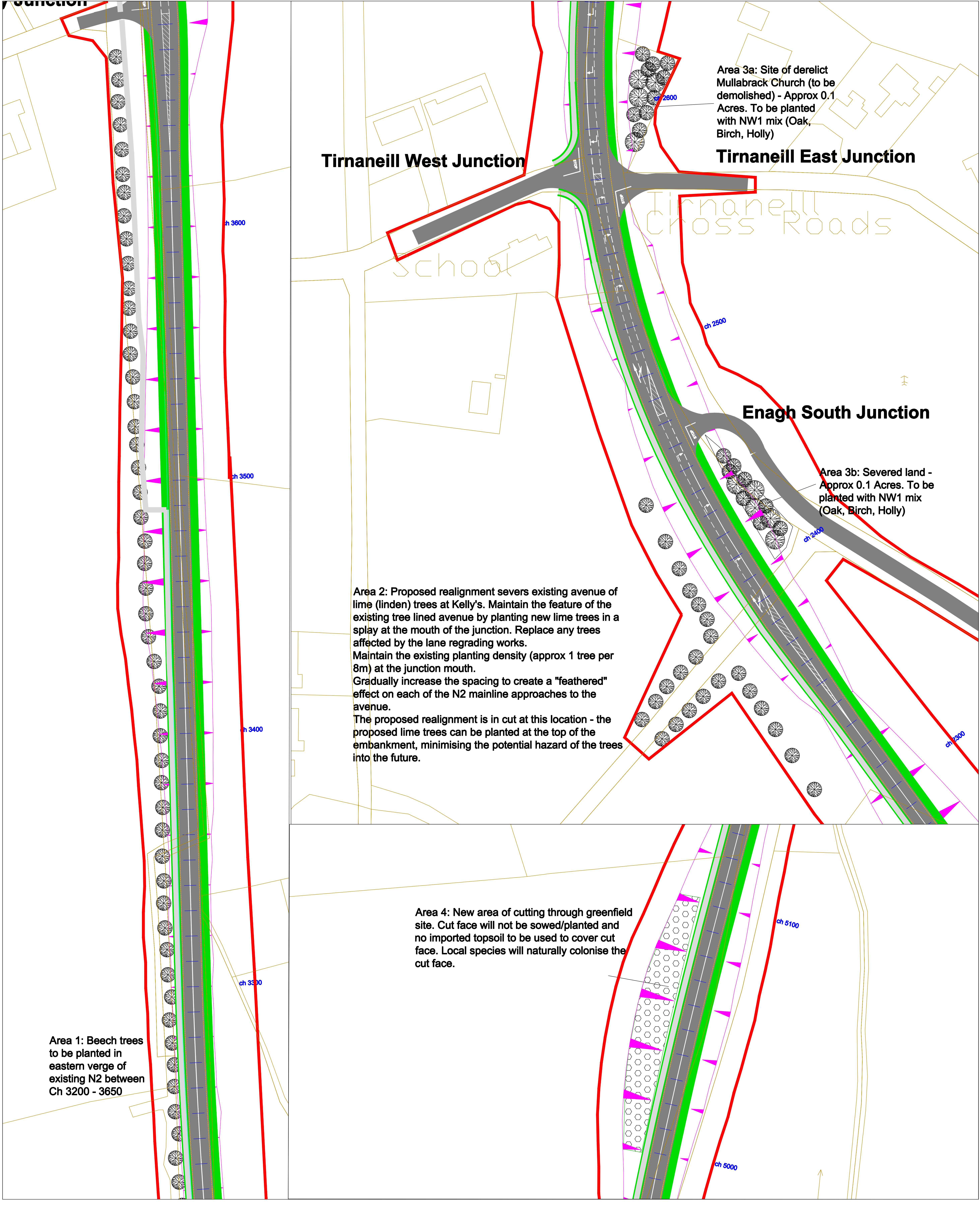

Area 3a: Site of derelict Mullabrack Church (to be demolished) - Approx 0.1 Acres. To be planted with NW1 mix (Oak, Birch, Holly)

Tirnaneill West Junction

Tirnaneill East Junction

Area 2: Proposed realignment severs existing avenue of lime (linden) trees at Kelly's. Maintain the feature of the existing tree lined avenue by planting new lime trees in a splay at the mouth of the junction. Replace any trees affected by the lane regrading works. Maintain the existing planting density (approx 1 tree per 8m) at the junction mouth. Gradually increase the spacing to create a "feathered" effect on each of the N2 mainline approaches to the avenue. The proposed realignment is in cut at this location - the proposed lime trees can be planted at the top of the embankment, minimising the potential hazard of the trees into the future.

Area 3b: Severed land - Approx 0.1 Acres. To be planted with NW1 mix (Oak, Birch, Holly)

Enagh South Junction

Area 4: New area of cutting through greenfield site. Cut face will not be sowed/planted and no imported topsoil to be used to cover cut face. Local species will naturally colonise the cut face.

Area 1: Beech trees to be planted in eastern verge of existing N2 between Ch 3200 - 3650

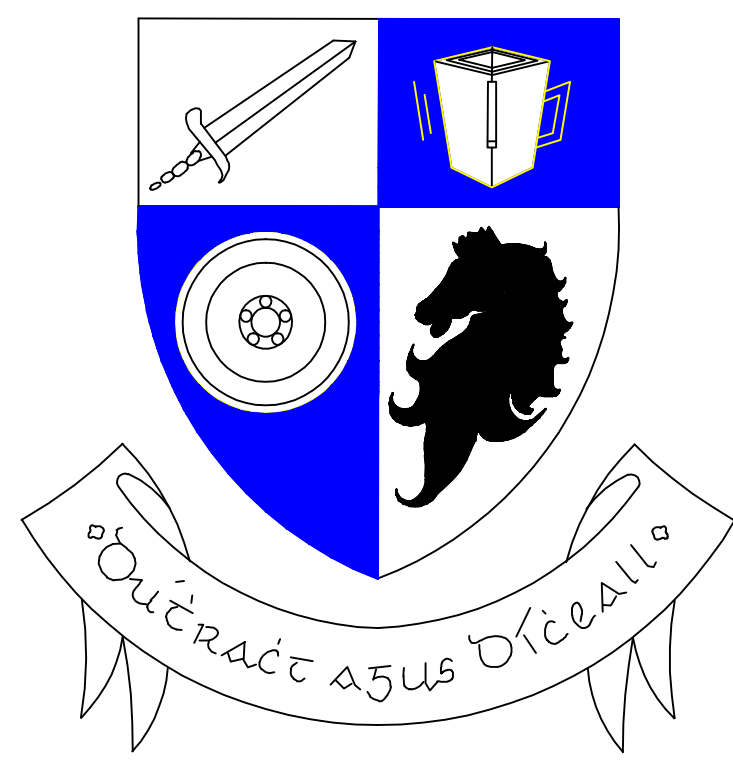

Project
N2 Monaghan to Emyvale Road Improvements
Coolkill East to Corracrin

Title
Key Landscaping Proposals
Area 1, 2, 3, 4
Ref Section 4.3.6 of Development Description

A/Director of Services		Damien Treanor	
Designed	RNAI	Date	
Drawn	RNAI	7 July 2011	
Traced		Scales	
Surveyed		1:500	
Checked			

Comhairle Contae Mhuineacháin,
Oifigi Contae,
An Gleann,
Muineachán.
Guthán: 047 30500
Monaghan County Council,
County Offices,
The Glen, Monaghan.